

Accompanying Guidance Notes should be read before completing this form.

Note: Details provided in Parts 1 and 2 will be made available for public inspection. Details provided in Part 3 are confidential and are not for public disclosure.

USE BLOCK CAPITALS IN BLACK INK

For Office Use

Application Ref. No.

Date of receipt, (Dept. Stamp)

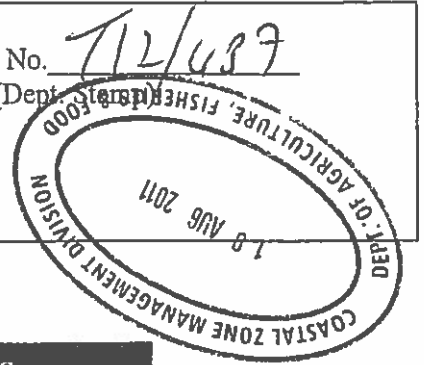

PART 1: PRELIMINARY DETAILS

Name(s) of Applicant(s) in full:	
1.A	Sohn Christopher M ^c Kinney
1.B	
Address(es) of Applicant(s) in full:	
1.A	Harbour View, Greencastle, Co. Donegal.
1.B	
RSI/PPS No./CRO No:	
Tel:	Fax:
Tel:	Fax:

1.C TYPE OF APPLICATION

Indicate the relevant type of application:

Insert X in relevant box

- (i) Aquaculture Licence
- (ii) Trial Licence
- (iii) Review of Aquaculture Licence
- (iv) Renewal of Aquaculture Licence
- (v) Foreshore Licence

Trawling
Bay
Pacific Oysters

X

(This Application Form is valid for each type of application)

X
X

(1) - Ordnance Survey Map (Scale of 1: 10,560, ie, a six inch map) **OBLIGATORY**

☒

(2) - British Admiralty Chart (largest available scale)

☒

(3) - Decision of planning authority under Planning Acts

☐

(4) - Copy of licence under Section 4 of Local Government
Water Pollution) Act, 1977

☐

(5) - Environmental Impact Statement

☐

(6) - Drawing of the structures to be used and/or the layout of the farm **OBLIGATORY**

☒

(7) - Water Quality Analysis Report (required for Land-based sites only)

☐

(8) - Application Fee **OBLIGATORY**

☒

(9) - Other (specify): The site I am applying for is an extension
to sites ~~1477~~, south of sites 1477 and B55A and to
south and west of site 336A.

PART 2: DETAILS RELATING TO PROPOSED AQUACULTURE PROJECT

2.A Employment, Qualifications, Experience, Etc.

(i) Details of Applicant's qualifications and experience in aquaculture:

I have been farming oysters
since 1991.

(ii) Other relevant experience (courses attended, etc):

(iii) Details of projected employment creation during first four years of proposed development:

At present I have one man employed
part time + myself.

(iv) Projected employment (number of persons):

Year 1:

Year 2:

Year 3:

Year 4:

Indicate type of site:

- (i) Land-based
- (ii) Marine-based

<input type="checkbox"/>
<input checked="" type="checkbox"/>

2.C. Land-Based Site

(To be completed if appropriate)

(i) State species to be farmed: _____

N/A

(ii) State proposed system of culture e.g., pond, raceway, circular tank or other method: _____

N/A

(iii) Full address of proposed site including Townland and County: _____

(iv) Tonnage to be produced:

Year 1:		Year 2:		Year 3:		Year 4:	
---------	--	---------	--	---------	--	---------	--

(v) Proposed source of stock: _____

(vi) Name of river(s) supplying site with water: _____

N/A

(vii) Estimate drought flow in gallons per minute: _____

(viii) Is there a fall of 1.5 metres in the water level at this site or can this be obtained by damming the river without giving rise to flooding of your own or neighbour's land upstream of the site? _____

(ix) Area of proposed site (hectares): _____

(x) Details of services available on the site e.g., main road access, electricity: _____

N/A

(xi) Are there at present any possible sources of pollution upstream of the site, e.g. discharge from sewerage plant, farmyard, sheep dip facility, silage effluent, quarry, sandpit or factory? YES ☐ NO ☐

(xii) If yes, supply details: _____

N/A

Land-based Site (continued)

2.D The following must be supplied:

- (i) Sketch of the layout of the site in relation to the river(s), road(s) and buildings;
- (ii) Water quality Analysis Report, which should be drawn up in accordance with the parameters set out in Annex C of the Guidance Notes.

2.E The following conditions must be met in order to allow for consideration of licensing of land-based aquaculture:

- (i) the buildings and equipment must be put in place to the Department's satisfaction; and
- (i) the operation must comply with Local Authority requirements.

2.F Marine-based Site(s)

(To be completed if appropriate)

Location - (i) Bay:

Trabreaga Bay Malin

- (ii) County:

Donegal

(iii) OS Map No:

PLEASE SEE ATTACHED

(iv) Site Co-ordinates

PLEASE SEE ATTACHED

(v) Size (hectares):

4

(vi) Species (common and scientific name):

Giga Oysters

- Aquatic Plant(s)

- Any form of aquatic food suitable for the nutrition of fish

(vi) Method of culture (e.g., nets, ropes, tanks, trestles, etc.)

Trestles + Bags

(vii) Drawings of structures to be used in method of culture should be enclosed.

~~Already submitted~~

(viii) If cages or tanks are proposed, state:

N/A

Previous applications
→ PLEASE FIND ATTACHED

- (a) Number:

- (b) Type and shape:

- (c) Cubic Capacity:

- (d) Depth:

(ix) Proposed specific site locations (with reasons):

The site I am now applying for is an extension of sites owned and operated by me. The proposed new site would be impacting on no-one.

(x) Describe proposed purification facilities to be used, where appropriate:

2.G Give details of any special requirements relating to the health of the proposed project and the wider matters of public health and safety:

2.H Tonnage to be produced:

Species
(To state)

Year 1:

Year 2:

Year 3:

Year 4:

This site would supplement my present production.

2.I Reasons for selection of site(s):

It is a continuation of sites I already operate.

Note: The proposed access route to the site(s) from public road across tidal foreshore area Must be indicated on the OS map accompanying the application.

2.J Environmental Impact Statement (EIS).

A copy of an EIS, if required, should be enclosed with the application. The EIS should contain the information specified in Annex B of the Guidance Notes.

N/A

2.K Trial Licence.

(To be completed if appropriate)

Describe experimental or investigative nature of the proposed project:

I have been farming oysters since 1991.

[Use separate page if required - to be signed and dated]

B. MARKETING (continued)

3. Will the product be processed or packaged?

YES

☐

NO

☒

4. If yes, give details:

I/We hereby declare the information provided in Parts 1, 2 and 3 above to be true to the best of my/our knowledge. I/We enclose an application fee* of € 95.23 with this application.

Signature(s) of Applicant(s):

John C. M. Henney

Date:

8th June 2011

*Preferred method of payment is by cheque or bank draft. The fee should be made payable to the Department of Agriculture, Fisheries and Food.

This form should be forwarded, with the required documents and application fee, to:

Aquaculture Licensing
Aquaculture & Foreshore Management Division
Clogheen
Clonakilty,
Co. Cork

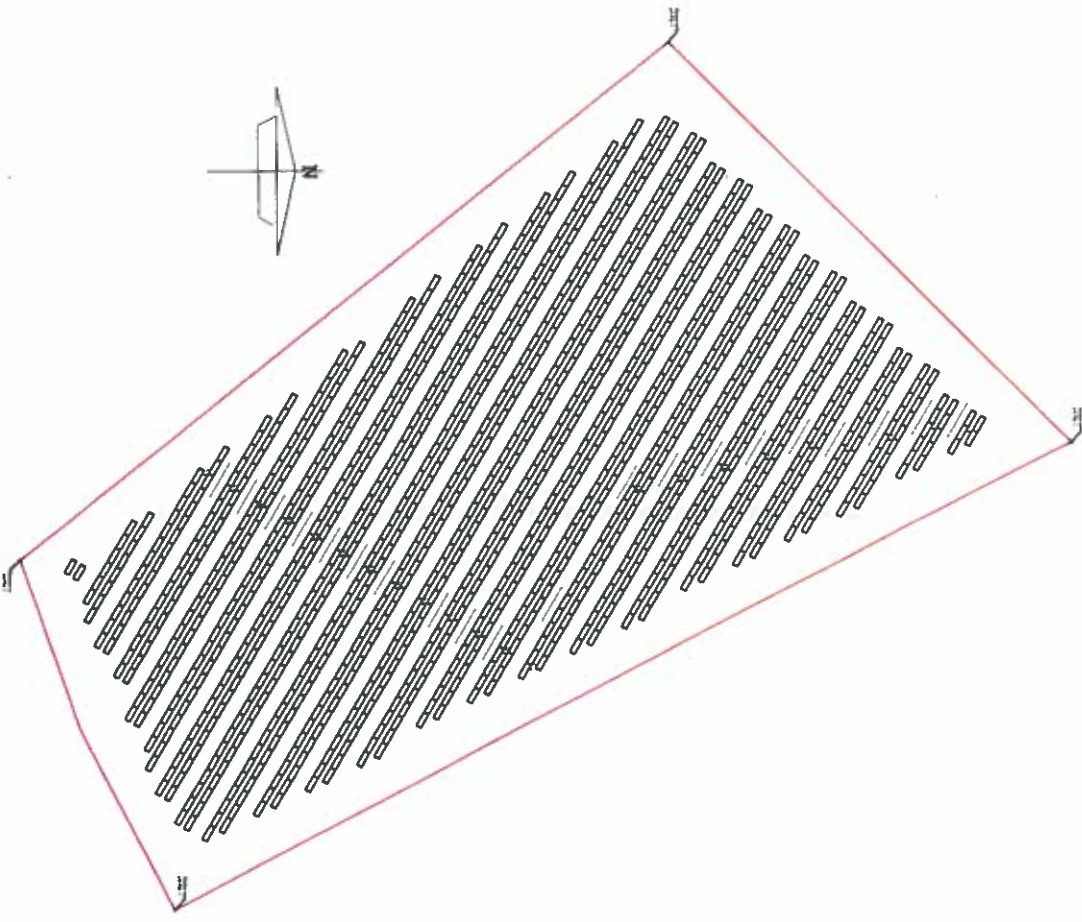

Proposed Trestle Layout Scale: 1/1000

Aquaculture Licence Application			
Ordinance Survey Ireland Licence No. A30016016			
© Ordnance Survey Ireland, Government of Ireland			
DESIGNED BY	DRAWN BY	CHECKED BY	DATE
October House Design Ltd.			
The Mullins			
Knader Rd			
Ballyshannon			
C.O. Donegal			
<small> This drawing is the property of October House Design Ltd. and is not to be used, copied, reproduced or otherwise disclosed without the written permission of October House Design Ltd. </small>			
<small> Trestle Layout For Site T12/437A on behalf of John & Shaun McKinney. </small>			
<small> Typical Block Layout Scale: 1:1000 Date: Aug 2016 </small>			
17			

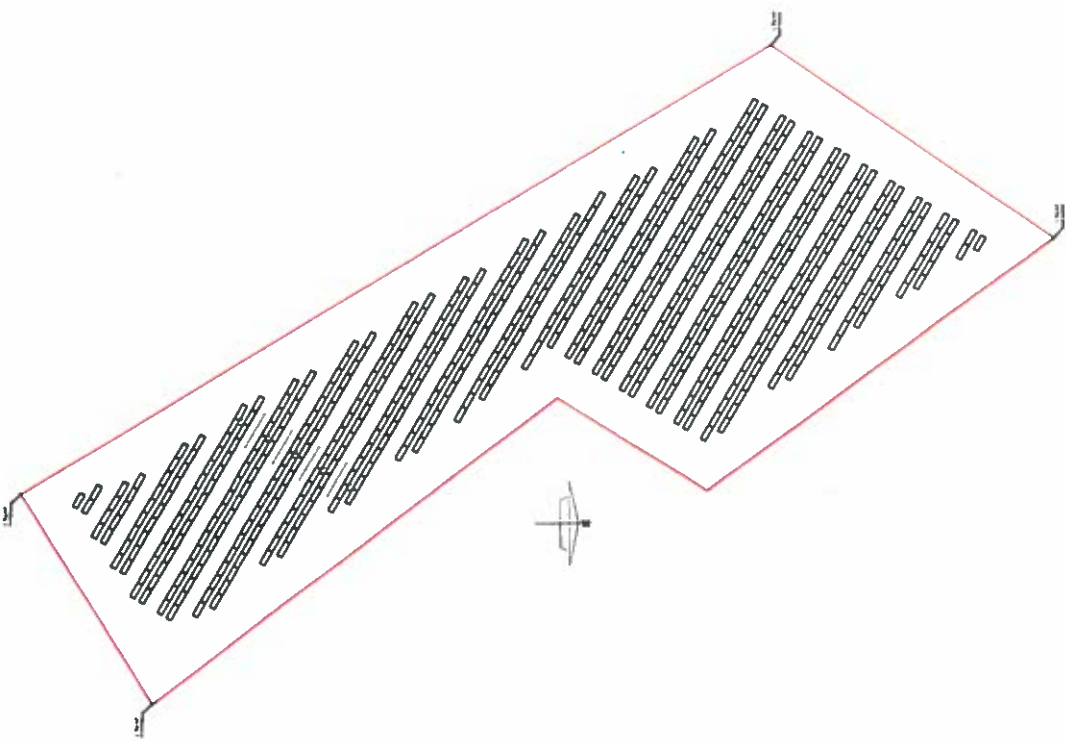

Proposed Trestle Layout Scale: 1/1000

Aquaculture Licence Application			
Ondusca Survey Ireland Licence No. A10016016			
Ondusca Survey Ireland, Government of Ireland			
DRAWN	DATE	PROJECT	
OCTOBER HOUSE DESIGN LTD. The Mullins Knader Rd Ballyshannon Co. Donegal Ireland (EN94 21775) Email: info@octoberhouseing.com Tel: 0949 221175 Website: www.octoberhouseing.com All rights reserved. No part of this publication may be reproduced without permission in writing from the publisher.			
			
Trestle Layout For Site T12/437B on behalf of John & Shaun McKimney.			
Typical Block Layout Scale: 1:1000 Date: 21 Aug 2016			

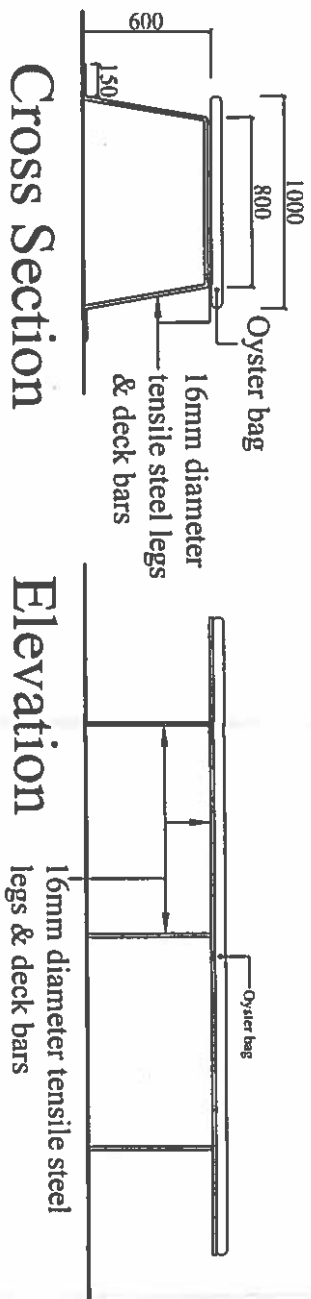

Cross Section

Elevation

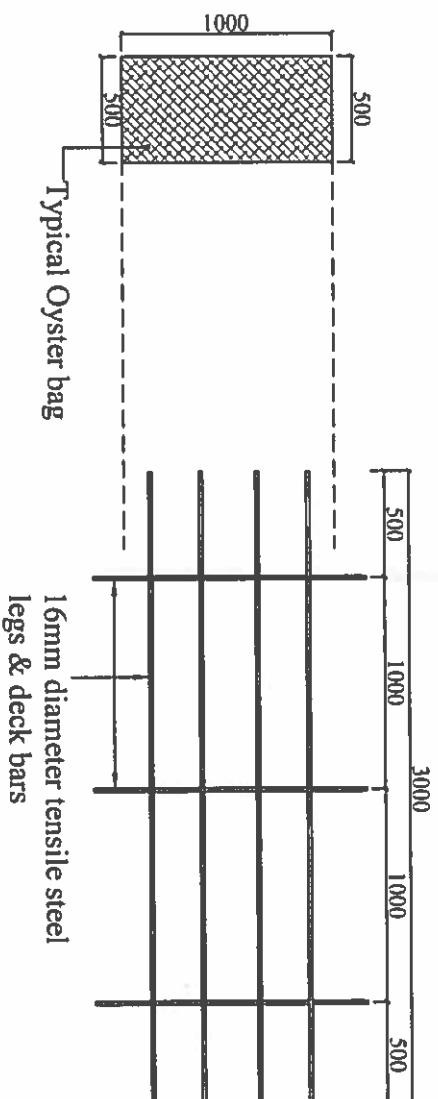

Plan (Oyster bags not shown for clarity)

Typical Trestle Detail

Fig. 1

Scale: 1/25

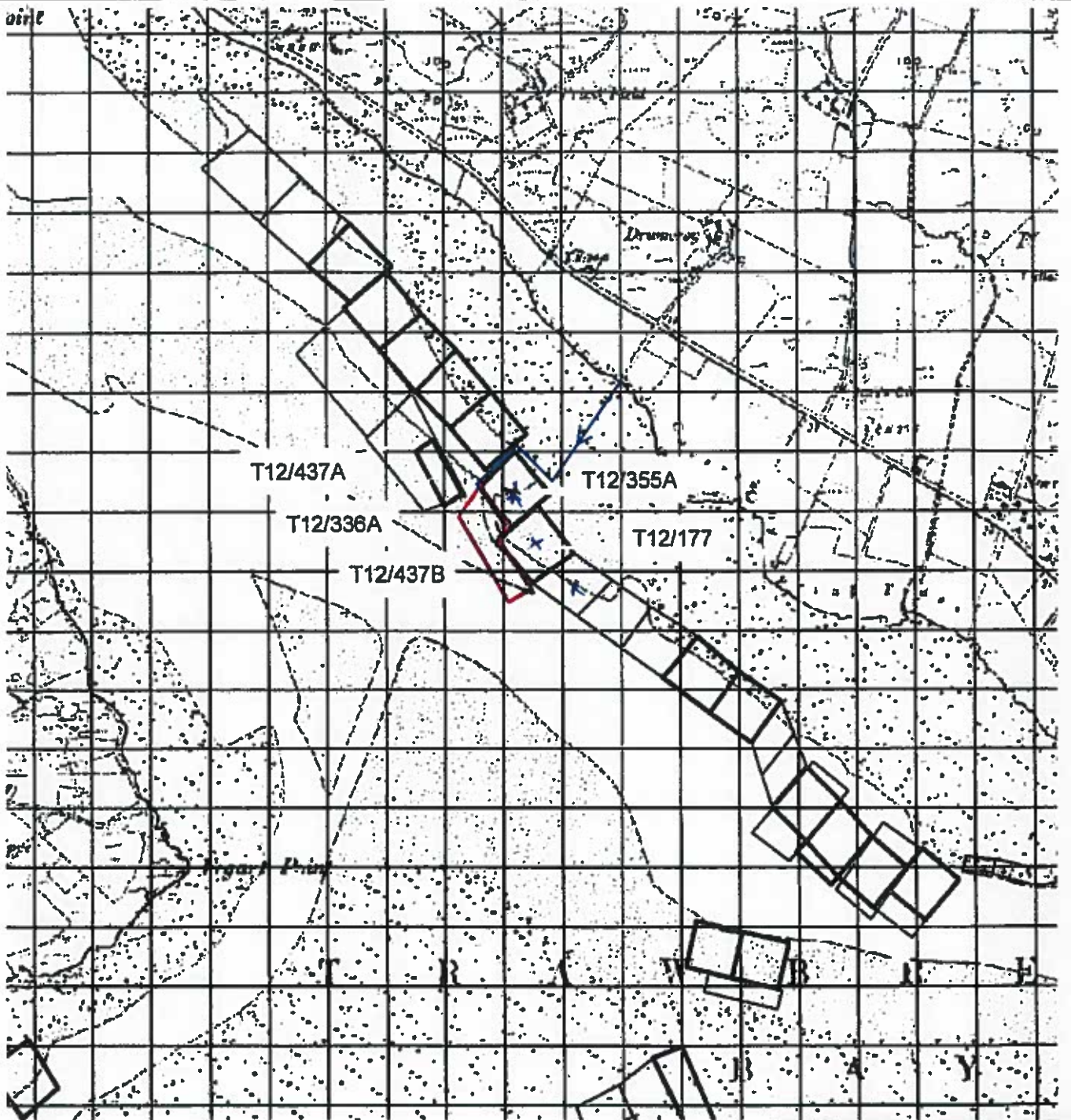

Access Route Map

Scale: 1/10,000

Aquaculture Licence Application

Ordnance Survey Ireland License No. AR0016016

© Ordnance Survey Ireland, Government of Ireland

DRAWN

CHECKED

© COPYRIGHT OF

October House Design Ltd.

The Mullins

Knader Rd

Ballyshannon

Co. Donegal

J. Martin McLaughlin B.ENG(Hons), C.ENG, M.I.E.I.

Mobile: (086) 2217173

Email: info@octoberhouse.org

No permission is to be sought from this drawing or otherwise to be
 displayed by the applicant on any other or subsequent to be
 required to the applicant to change



TITLE

Proposed Access Route to Site
 T12/437B on behalf of John &
 Shaun McKinney.

DRAWING

Proposed Access Route

SCALE 1/10,000

O.S. ref.

DRG NO.

REV.

DATE Aug 2016

23

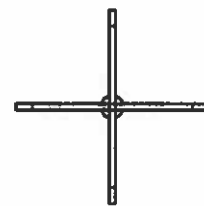
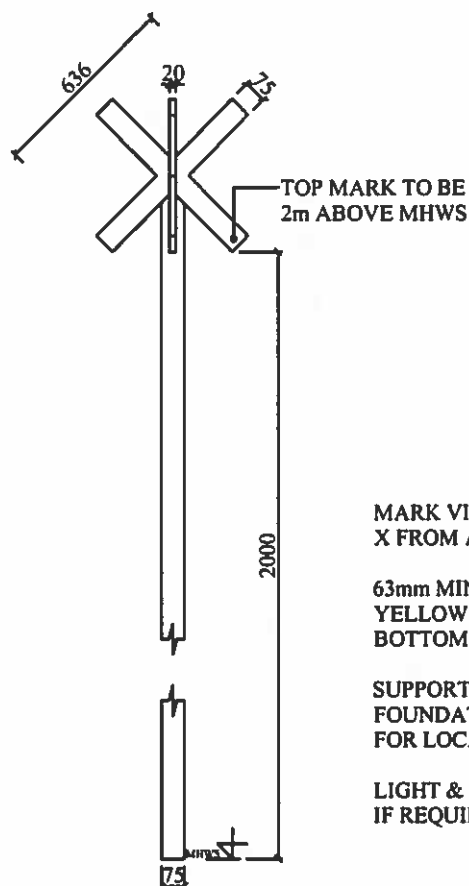

Plan: Special Mark Beacon

MARK VISIBLE AS YELLOW
X FROM ALL DIRECTIONS.

63mm MIN DIAMETER POLE -
YELLOW FOR 2 METERS BELOW
BOTTOM OF CROSS.

SUPPORT STRUCTURE &
FOUNDATION SUITABLE
FOR LOCATION.

LIGHT & RADAR REFLECTOR
IF REQUIRED.

Elevation: Special Mark Beacon

Special Mark Beacon Detail Fig. 2

Scale: 1/25

Aquaculture Licence Application			
Ordnance Survey Ireland License No. AR0016016			
© Ordnance Survey Ireland, Government of Ireland			
DRAWN	CHECKED		
© COPYRIGHT OF October House Design Ltd. The Mullins Knader Rd Ballyshannon Co. Donegal J. Martin McLaughlin B.ENG(Hons), C.ENG, M.I.E.I. Mobile: (086) 2217173 Email: info@octoberhouse.org <small>No dimensions to be coded from this drawing all dimensions to be checked by the company on site any errors or discrepancies to be reported to the engineer in charge</small>			
			
TITLE Special Mark Beacon Detail For Site T12/437B on behalf of John & Shaun McKinney.			
DRAWING Special Mark Beacon Detail			
SCALE 1/25	C.I. REF.	DWG NO.	REV.
DATE Aug 2016		24	

1 NO. SITE AT TRAWBREAGA BAY CO.DONEGAL

Co-ordinates & Area

Site T12/437A (0.4049 Ha)

The area seaward of the high water mark and enclosed by a line drawn from Irish National Grid Reference point

244650, 450400 to Irish National Grid Reference point

244700, 450310 to Irish National Grid Reference point

244664, 450301 to Irish National Grid Reference point

244610, 450368 to the first mentioned point.

244000

245000

451000

451000

450000

450000

244000

245000

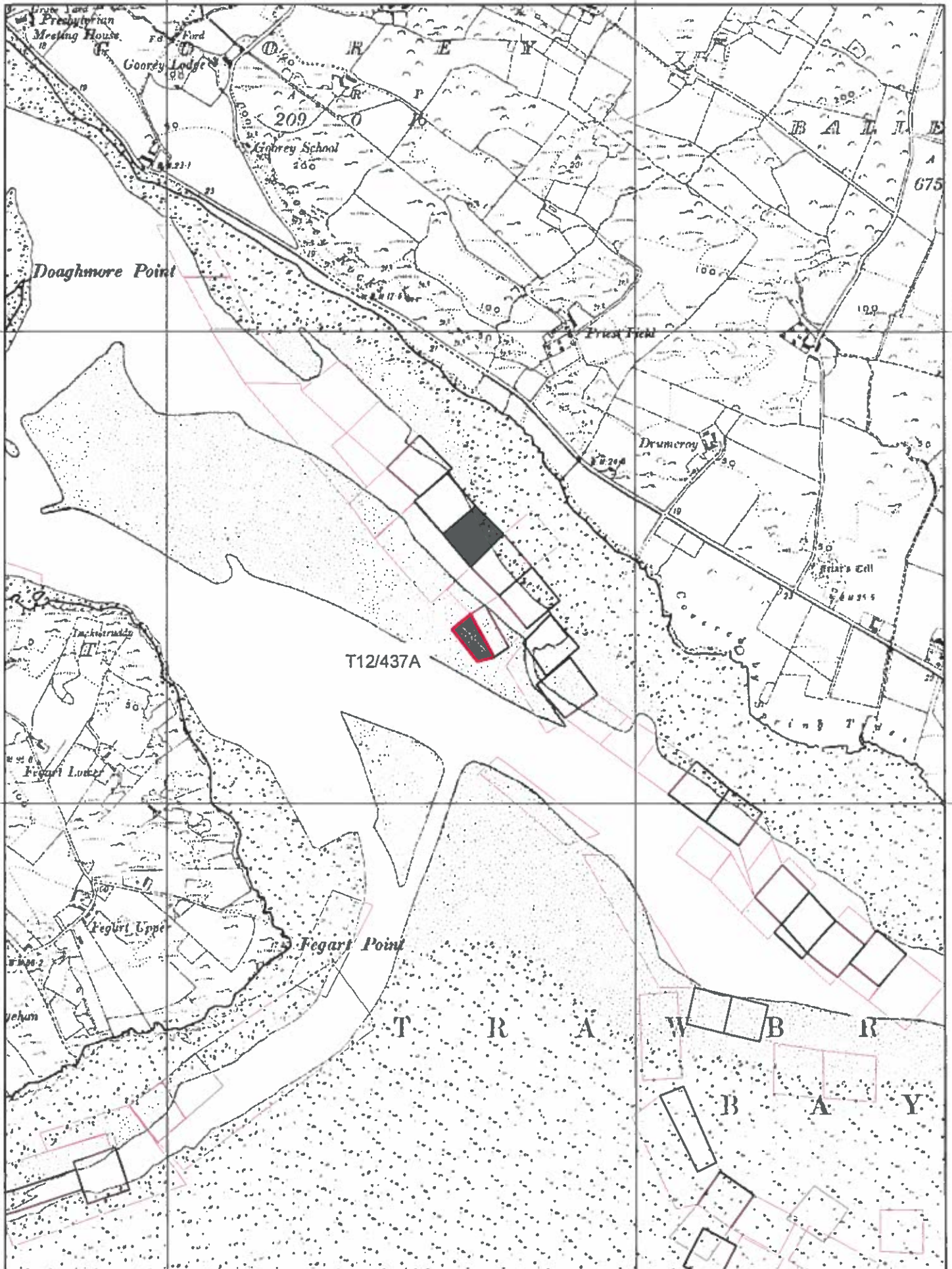

T12/437A

1:10,560

Sites highlighted in red denotes Application

Ordnance Survey Ireland Licence No. EN 0076413
 © Ordnance Survey Ireland/Government of Ireland

Aqua Culture Sites
 Site Status
 Application
 Licensed
 Refused
 Revoked
 Suspended
 Withdrawn

1 NO. SITE AT TRAWBREAGA BAY CO.DONEGAL

Co-ordinates & Area

Site T12/437B (0.8617 Ha)

The area seaward of the high water mark and enclosed by a line drawn from Irish National Grid Reference point

244760, 450340 to Irish National Grid Reference point
244810, 450270 to Irish National Grid Reference point
244788, 450251 to Irish National Grid Reference point
244850, 450180 to Irish National Grid Reference point
244810, 450148 to Irish National Grid Reference point
244725, 450292 to the first mentioned point.

244000

245000

451000

451000

450000

450000

449000

449000

244000

245000

Aqua Culture Sites
 Site Status
 Application
 Licensed
 Renewed
 Revoked
 Suspended
 Withdrawn
 100 Meter Reference Grid

1:10,560

Sites highlighted in red denotes Application

Ordnance Survey Ireland Licence No. EN 0076413
 © Ordnance Survey Ireland/Government of Ireland



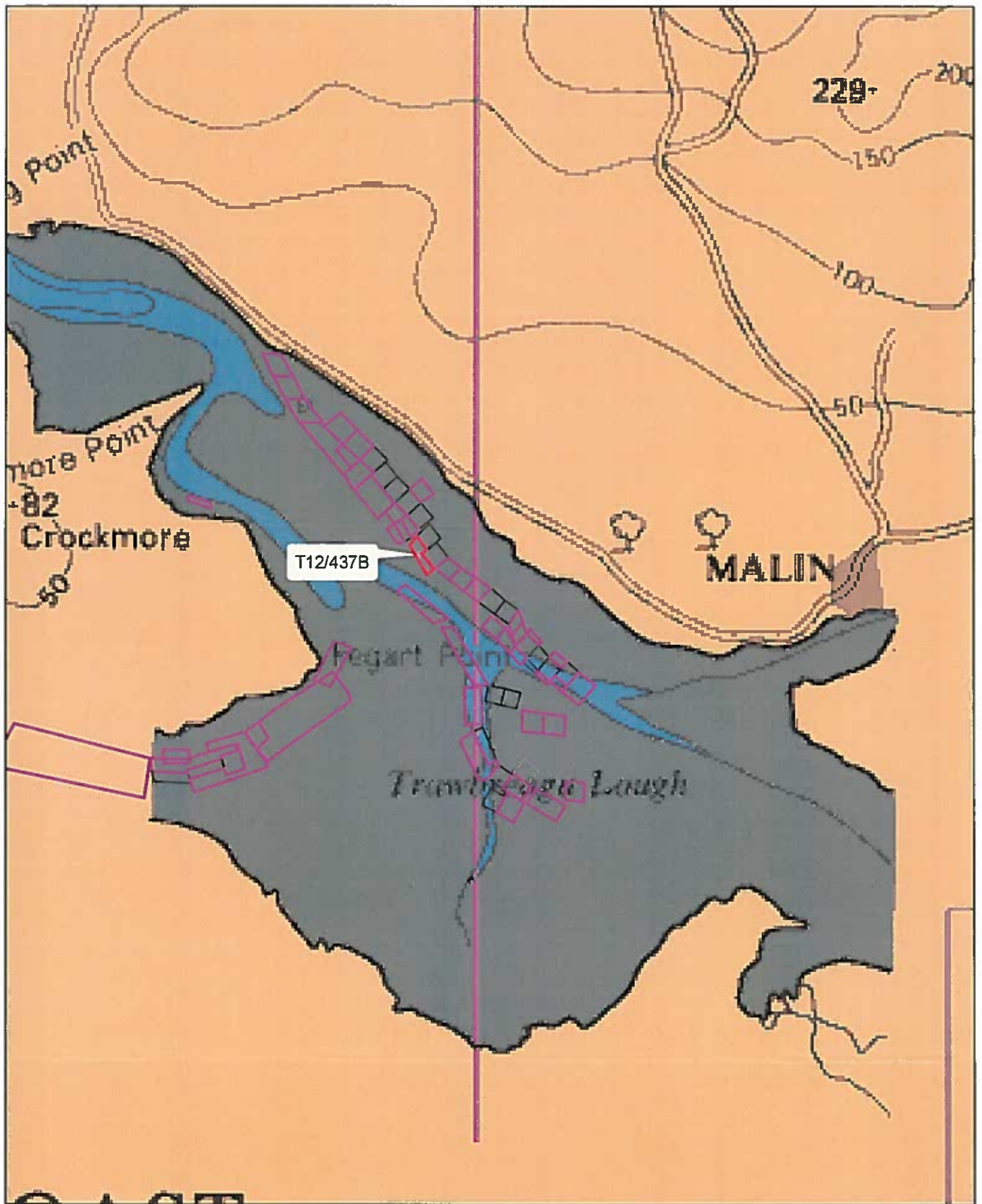

1:24,000

Sites highlighted in red denotes Application
Part of Admiralty Chart No =2811-0
Not to be used for Navigation

Aqua Culture Sites
not prior volume

Site Status

- Application
- Licensed
- Refused
- Renewal
- Revoked
- Surrendered
- Withdrawn
- 100 Meter Reference Grid