

AQUACULTURE AND FORESHORE LICENCE APPLICATION FORM, for purposes of
FISHERIES (AMENDMENT) ACT, 1997 and FORESHORE ACT, 1933

NB: The accompanying Guidance Notes should be read before completing this form.

Note: Details provided in Parts 1 and 2 will be made available for public inspection. Details provided in Parts 3 and 4 and any other information supplied will not be released except as may be required by law, including the Freedom of Information Act 1997 as amended.

**USE BLOCK CAPITALS IN BLACK INK
PLEASE**

For Office Use

Application Ref. No. T12/375

Date of Receipt (Dept. Stamp)



Type of Applicant (tick one)

Sole Trader

☐

Partnership

☐

Company

Name Barr Oysters Ltd ✓

☒

Co-Operative

☐

Other

Please specify-

☐

PART 1: PRELIMINARY DETAILS

Applicant's Name(s)

1.

Address:

Barr Oysters Ltd.
Michael Barr.

Fogle Water View
Ballymacanthur Green Castle

2.

Address:

Co Donegal

3.

Address:

4.

Address:

Contact in case of enquiries (if different from above)	
Contact Name	
Organisation Name (if applicable)	
Address	

PART 1: PRELIMINARY DETAILS

TYPE OF APPLICATION – please indicate relevant type of application	
This Application Form is valid for each type of application - <i>See Guidance Note 3.1</i>	
(i) Aquaculture Licence	<input type="checkbox"/>
(ii) Trial Licence	<input type="checkbox"/>
(iii) Foreshore Licence, if Marine Based	<input type="checkbox"/>
(iv) Review of Aquaculture Licence	<input type="checkbox"/>
(v) Renewal of Aquaculture Licence	<input type="checkbox"/>

TYPE OF AQUACULTURE

See Guidance Note 3.2

Indicate the relevant type of application with a tick.

(i) MARINE-BASED

- | | | |
|--|-------------------------------------|--------------------------|
| Finfish | <input type="checkbox"/> | Go to Parts 2.1 and 2.1A |
| Shellfish <i>Subtidal</i> | <input type="checkbox"/> | Go to Parts 2.2 and 2.2A |
| <i>Intertidal</i> | <input checked="" type="checkbox"/> | Go to Parts 2.2 and 2.2A |
| Seaweed/Aquatic Plants/Aquatic Fish Food | <input type="checkbox"/> | Go to Parts 2.3 and 2.3A |

(ii) LAND-BASED

- | | | | | |
|----------------|--------------------------|-------------------|--------------------------|--------------------------|
| Finfish | <input type="checkbox"/> | Shellfish | <input type="checkbox"/> | Go to Parts 2.4 and 2.4A |
| Aquatic Plants | <input type="checkbox"/> | Aquatic Fish Food | <input type="checkbox"/> | Go to Parts 2.4 and 2.4A |

(iii) TRIAL LICENCE

☐

Go to appropriate Parts as above and to Part 2.5.

2.2 MARINE-BASED SHELLFISH AQUACULTURE

When filling out this section refer also to 2.2A and Guidance Note 3.3 for information on Conditions and Documents required with this application type

Proposed Site Location

- (i) Bay: DONAGAL TRAWBREAGA
- (ii) County: DONEGAL
- (iii) OS Map No: 64
- (iv) Co-ordinates of Site: (please specify coordinate reference system used e.g. Irish Grid (IG) or Irish Transverse Mercator (ITM) or Latitude/Longitude [in which case specify whether ETRS89 or WG84 etc.] ITM)
① 245312, 449744 ② 245366, 449684
③ 245354, 449671 ④ 245295, 449726
- (v) Size of Site (hectares): 0.17 Ha

(vi) Species (common and scientific name) and whether native or non-native species: (see Guidance Notes 3.3.1)

GIGAS

(vii) Whether production will be sub-tidal or inter-tidal? INTER-TIDAL

(viii) Please supply details of (a) source of seed e.g. wild hatchery and location and (b) means of collection and introduction to culture.

① Wild ② Hand

NB Importation of seed into the State or movement of seed within the State requires notification to the Marine Institute as per the Fish Health Authorisation Regulations – See Guidance Notes Section 6

(ix) Method of culture (rope, trestles – intensive; bottom – extensive; other) BAGS + TRESTLES

(x) Proposed number of lines/ropes/trestles as per site layout drawing

100

(xi) Proposed Production Tonnage:

Year 1	Year 2	Year 3	Year 4	Year 5
<u>15</u>	<u>20</u>	<u>20</u>	<u>20</u>	<u>20</u>

(xii) (a) Please outline the reasons for site selection:

Good Site access

(b) If using trestles please outline the physical characteristics of the site which make it suitable for using trestles

Good Firm Ground.

(xiii) Is it intended that the product is for direct human consumption or half grown? Please specify

☒ Direct Human Consumption

(xiv) How will the visual impact issues of the flotation devices for the proposed application be addressed?

N/A.

(xv) Is the site located in Designated Shellfish Waters Area? (Refer to Guidance Note 3.3.2)

Yes

☐

No

☒

If yes give details.

Please find attached map.

If no outline the reasons why you believe the site suitable for the proposed aquaculture, notwithstanding its location outside Designated Shellfish Waters Area?

(xvi) Has the area been classified under Food Safety Legislation? (For Bivalve Molluscs) What is the current classification of the area for the proposed species applied for?

Yes - Class B.

(xvii) Is the site located in/adjacent to a sensitive area e.g. SPA (Special Protection Area) or SAC (Special Area of Conservation) i.e. a Natura 2000 site? (Refer to Guidance Note 3.3.1- Natura 2000 sites)

Yes.

(xviii) Are there known sources of pollution in the vicinity e.g. sewage outfall?
If yes please give full details.

Yes / No

NO.

(xix) Methods used to harvest the shellfish and details of any subsequent processing of shellfish

By hand.

(xx) Describe any proposed purification facilities to be used:

N/A.

(xxi) What are the main predators of the species to be cultivated?

(xxii) Describe the method(s) which will be used to control them

See Part 2.2A for details of documentation to be included with this application type

2.2A DOCUMENTATION REQUIRED FOR MARINE-BASED SHELLFISH AQUACULTURE

(to be included separately with a Licence Application for a new site or for a renewal or review of an existing Licence)

1. An appropriate Ordnance Survey Map (recommendation is a map to the Scale of 1:10,000/1:10,560, i.e. equivalent to a six inch map). Note: The proposed access route to the site from the public road across tidal foreshore must also be shown on the map.
2. Scale drawing of the structures to be used and the layout of the farm.
The proposed site drawings must illustrate all site structures above and below the water including mooring blocks. (recommended scales normally 1:100 for structures and 1:200 for layout) (See Guidance Note 3.3.2)
3. The prescribed application fee (See Guidance Note Section 4)
4. If the applicant is a limited Company within the meaning of the Companies Act 1963, as amended, the Certificate of Incorporation and Memorandum and Articles of Association
5. If the applicant is a Co-operative, the Certificate of Incorporation and Rules of the Co-operative Society
6. Environmental Impact Statement (if required) in certain cases- See Guidance Notes Section 3.3.1
7. Alien Species dossier (where required) – See Guidance Notes Section 3.3.1

NOW COMPLETE PARTS 2.6, 3, 4 AND 5 PLEASE

2.6 Employment, Qualifications, Experience, etc.
TO BE FILLED IN BY ALL AQUACULTURE APPLICANTS

(i) Please provide details of experience/qualifications of the applicant and any key personnel which are relevant to the aquaculture now proposed:

*Over 15 years plus
Farming systems*

- (ii) If a new application please provide details of projected employment creation during first four years of the proposed aquaculture project:
 (iii) In the case of a renewal please provide current and future details:

He employed part-time

FULLTIME JOBS

Year 1:	<i>0</i>	Year 2:	<i>2</i>	Year 3:	<i>0</i>	Year 4:	<i>0</i>
---------	----------	---------	----------	---------	----------	---------	----------

PART TIME JOBS

Year 1:	<i>1</i>	Year 2:	<i>1</i>	Year 3:	<i>1</i>	Year 4:	<i>1</i>
---------	----------	---------	----------	---------	----------	---------	----------

PART 3 B. PARTNERSHIP

Partnership Name: BARR Oysters Ltd

Please list names, addresses, and Personal Public Service No.'s of partners:

Partner 1: Name and Address MICHAEL BARR
FOXLE WATER VIEW, BALLYMACARTHUR
GREENCASTLE CO. DUBLIN 2

Personal Public Service No. 1812372A

Date of Birth: 07/5/69

Partner 2: Name and Address _____

Personal Public Service No. _____

Date of Birth: _____

Partner 3: Name and Address _____

Personal Public Service No. _____

Date of Birth: _____

Partner nominated for contact purposes: _____

Full Name: _____

Address: _____

Phone No. _____

Mobile No. _____

E-mail Address: _____

PART 5: DECLARATION AND SIGNING

NB: Refer to Guidance Note Section 3.5 and Section 4 - Guidance on Declaration and Signing and Annual Aquaculture and Foreshore Licence Fees

If this is a renewal/review have you met all licence conditions of the existing aquaculture licence? If applicable, explain why you have not complied with all conditions:

Yes

I/We hereby declare the information provided in Parts 1, 2, 3 and 4 above to be true to the best of my/our knowledge. I/We enclose an application fee* of €

63-49.

Signature(s) of Applicant(s):
(Please state capacity of persons
signing on behalf of a Company/Co-op)

Michael Barn

Date:

10/6/16

**NB All persons named on this licence application must sign and date this application form.
Only the existing licence holder(s) can apply for the renewal/review of an Aquaculture Licence.**

*Preferred method of payment is by cheque or bank draft. The fee should be made payable to the Department of Agriculture, Food and the Marine.

Refer to Guidance Note Section 4 - Guidance on Aquaculture and Foreshore Licence Fees

The application form should be forwarded, with the required documents and application fee, to:

Aquaculture Licensing
Aquaculture & Foreshore Management Division
Department of Agriculture, Food and the Marine
National Seafood Centre
Clonakilty
Co. Cork

1 NO. SITE AT Trawbreaga Bay CO.Donegal

Co-ordinates & Area

Site T12/375A (0.171 Ha)

The area seaward of the high water mark and enclosed by a line drawn from Irish National Grid Reference point

245312, 449744 to Irish National Grid Reference point
245366, 449684 to Irish National Grid Reference point
245354, 449671 to Irish National Grid Reference point
245295, 449726 to the first mentioned point.

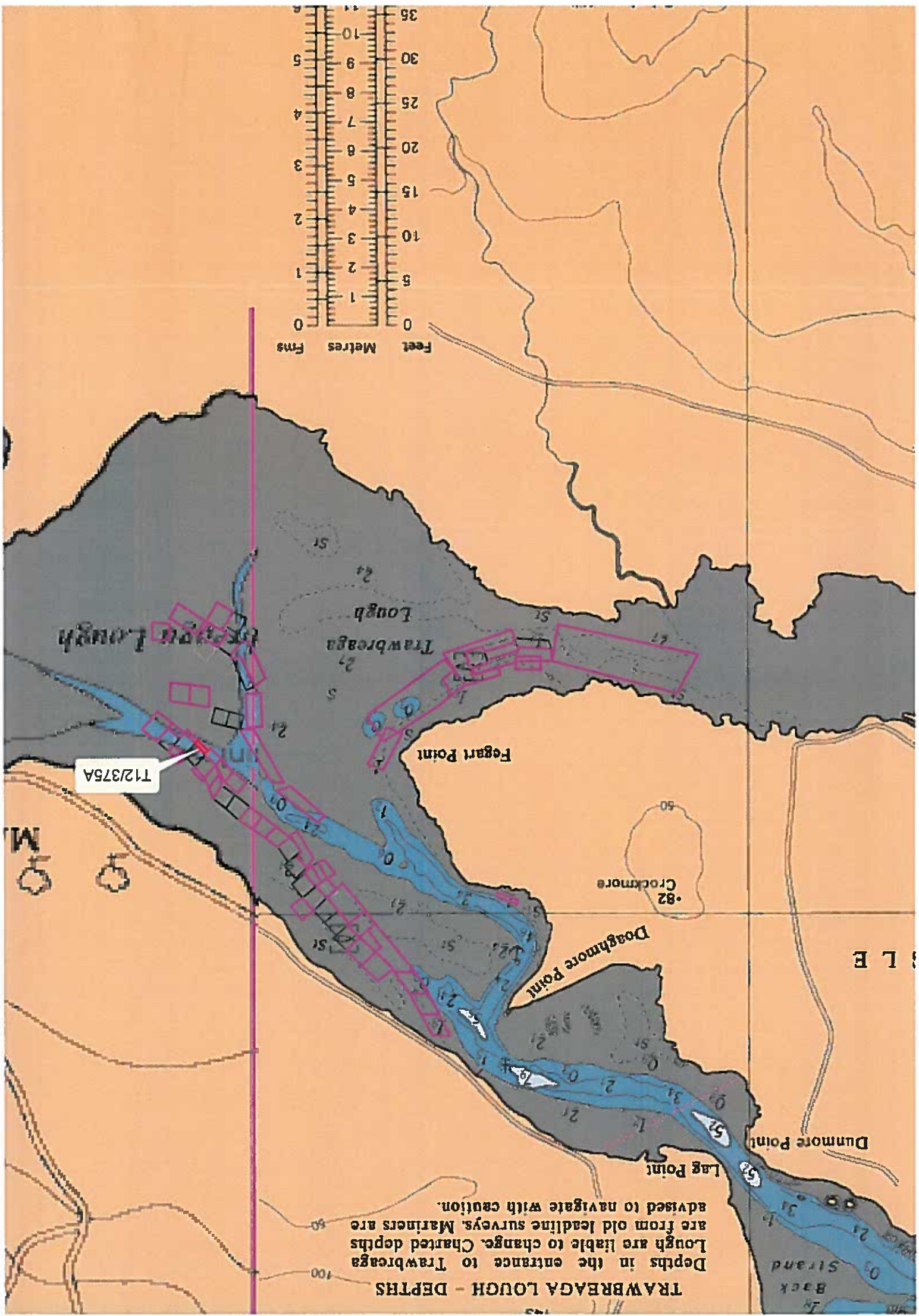

TRAWBREAGA LOUGH - DEPTHS

Depths in the entrance to Trawbreaga Lough are liable to change. Charted depths are from old leadline surveys. Mariners are advised to navigate with caution.

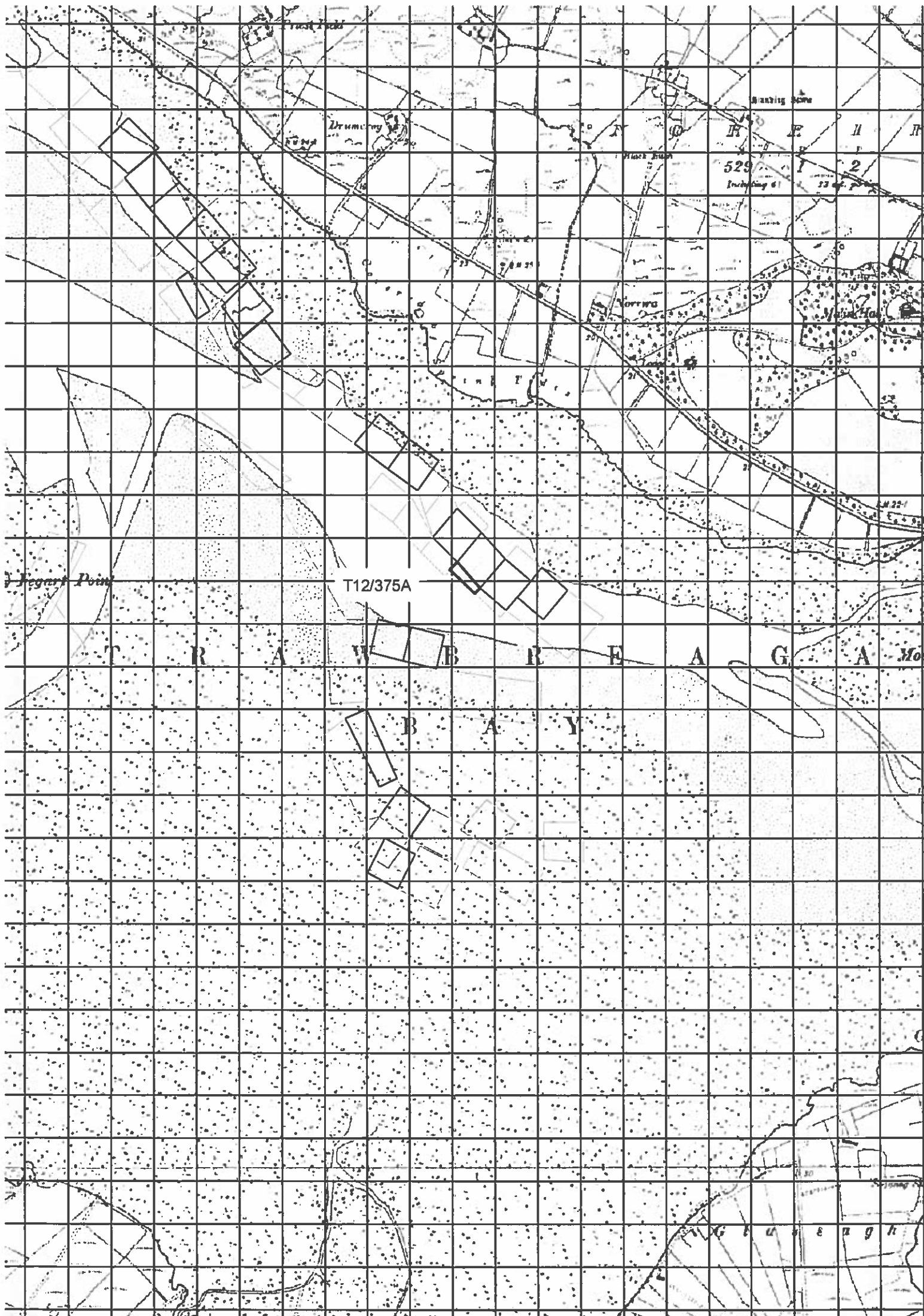

Truck Road

Drumming Pt

Black Bush

529

Including 61

33 ft

Black Bush

Mud Hole

Fogart Point

T12/375A

C R A W B E R E A G A Mo

B A Y

0 50 100

Feet

Drumeroy

B.M. 24.8

Access route map site 375A

Foreshore access shown as dashed red line

SCALE 1 : 5000

0 100 200 metres

50

Friar's Cell

B.M. 25.5

Norrira

Lodge

385A

383A

244

353A

227

384A

386A

358A

332

375A

333A

322

367A

A

W

B

R

E

R

A

V

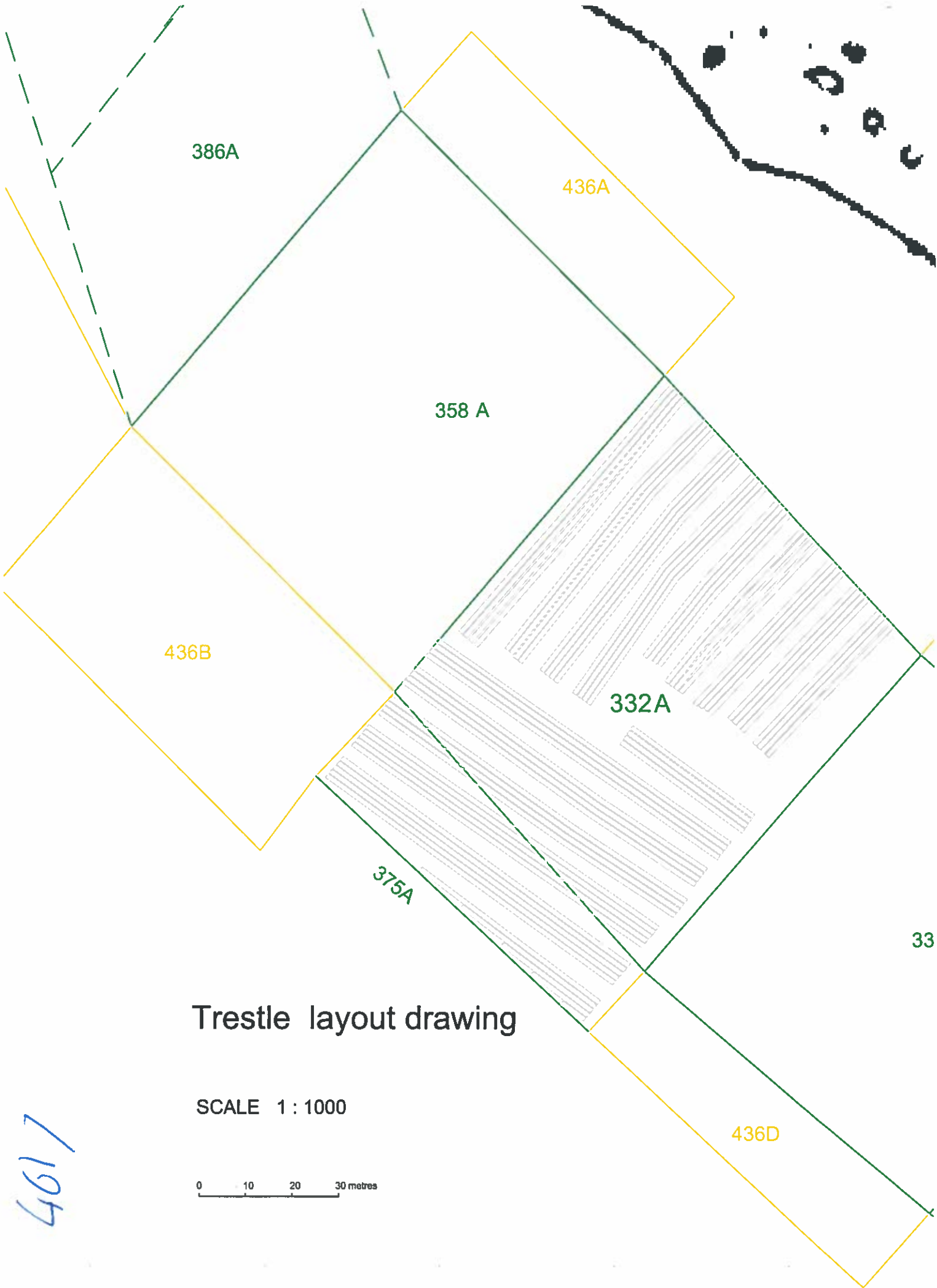

Trestle layout drawing

SCALE 1 : 1000

0 10 20 30 metres